

ECO Glass Columns



The Engineering Division of YMC Europe GmbH



ECO Glass Columns



- Lab scale to prep. scale
- Biocompatible
- ID 10 / 15 / 20 / 25 / 32 / 50 / 70 / 80 mm
- Length 120 / 200 / 450 / 750 / 1000 mm
- Available with one (“Vario”) or two (“Multivario”) adjustable pistons



ECO Glass Columns

- Up to 30 bar pressure limit
- AB-version (Aqueous Buffer)
POM / Viton[®] O-ring
- SR-version (Solvent Resistant)
PVDF / Kalrez[®] O-Ring
- Borosilicate glass tubing





ECO Glass Columns

- Temperature jacket (optional)
- Sintered glass frits 10 - 16, 16 – 40 or 40 - 100 μm
- AB-version for low temperature applications (4)
- Special glass lengths / frits on request





ECO Glass Columns



- ECO end pieces



ECO Glass Columns

Specifications

Bed length/Volume ECO series without jacket

ID [mm]	Pressure limit [bar]	Vario			Multivario		
		Bed length [mm]	Volume [mL]	price	Bed length [mm]	Volume [mL]	price
10	30	0-120	0-9.4	¥55,000	0-120	0-9.4	¥63,000
		80-200	6.3-16	¥56,000	0-200	0-16	¥64,000
		330-450	26-35	¥57,000	210-450	16.5-35	¥65,000
		630-750	50-59	¥58,000	510-750	40-59	¥66,000
		880-1000	69-79	¥59,000	760-1000	60-79	¥67,000
15	25	0-120	0-21	¥57,000	0-120	0-21	¥65,000
		80-200	14-35	¥58,000	0-200	0-35	¥66,000
		330-450	58-80	¥71,000	210-450	37-80	¥80,000
		630-750	111-133	¥82,000	510-750	90-133	¥91,000
		880-1000	156-177	¥90,000	760-1000	134-177	¥99,000
25	15	0-120	0-59	¥67,000	0-120	0-59	¥76,000
		80-200	39-98	¥70,000	0-200	0-98	¥79,000
		330-450	162-221	¥78,000	210-450	103-221	¥87,000
		630-750	309-368	¥89,000	510-750	250-368	¥98,000
		880-1000	432-491	¥101,000	760-1000	373-491	¥110,000
50	10	0-120	0-236	¥97,000	0-120	0-236	¥107,000
		80-200	157-393	¥101,000	0-200	0-393	¥111,000
		330-450	648-884	¥120,000	210-450	412-884	¥130,000
		630-750	1237-1473	¥131,000	510-750	1001-1473	¥141,000
		880-1000	1728-1964	¥144,000	760-1000	1492-1964	¥154,000
70	5	120-1000	462-3848		120-1000	462-3848	
80		120-1000	603-5026		120-1000	603-5026	

20mmI.D. and 32mmI.D. are also available.



ECO Glass Columns



- ECO coupler unit

- AB-version

POM / Viton®

- SR-version

PVDF / Kalrez®



Connection of Kronlab columns

Accessories of ECO columns:

- FEP - tubing
- 1/4" - 28G nut and ferrule (collapsible) (4 pc.)
- M6 nut (2 pc., metric thread)
- M6 ferrule (2 pc., metric thread)

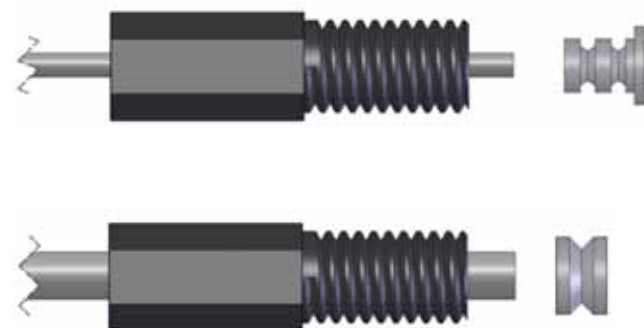



Example for column connection



Courtesy of InVivo GmbH



Courtesy of YMC Europe GmbH